

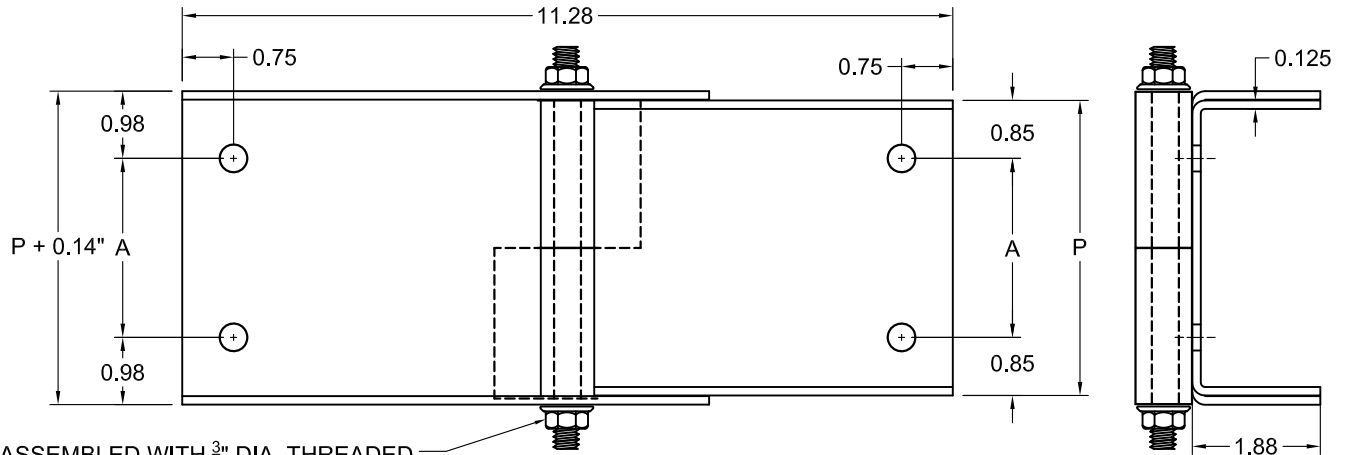

NO.	REVISION	BY	DATE	MATERIAL I.D.
0	APPROVED	TM	04-16-15	SPV



ASSEMBLED WITH $\frac{3}{8}$ " DIA. THREADED STUD AND (2) $\frac{3}{8}$ " FLANGED HEX NUTS, TYPE 316 STAINLESS STEEL (INCLUDED)

TWO CONNECTING PLATES SWIVEL VERTICALLY AROUND THE THREADED STUD

ADJUSTABLE

‡	CATALOG NUMBER	CHANNEL WIDTH		PLATE DIMENSIONS		PLATE QTY.
		W*	ACTUAL	P	A	
	SPV-AC3-(F*)4	3	3.00"	3.31"	1.62"	2
	SPV-AC4-(F*)4	4	4.00"	4.31"	2.62"	2
	SPV-AC6-(F*)4	6	6.00"	6.31"	4.62"	2

NOTES:

1. COMPLETE ASSEMBLY CONSISTS OF (2) ALUMINUM PLATES CONNECTED WITH A THREADED STUD AND (2) FLANGED HEX NUTS, TYPE 316 STAINLESS STEEL, AND FASTENERS INDICATED IN CHART.
2. INSTALL IN ACCORDANCE WITH NEMA STANDARD VE-2 CABLE TRAY INSTALLATION GUIDELINES.
3. THESE ARE THE STANDARD VERTICAL ADJUSTABLE SPLICE PLATE CONNECTORS FOR USE WITH ALL STANDARD CABLE CHANNEL SYSTEMS.

‡	F*	FASTENER MATERIAL	INCLUDED FASTENERS	FASTENER CATALOG NO.	QTY.
	G	GEOMET-PLATED STEEL	3/8" x 3/4" RIBBED-NECK SCREW	F-RNS-38-34-G	4
			3/8" FLANGED HEX NUT	F-FHN-38-G	4
	S	TYPE 316 STAINLESS STEEL	3/8" x 3/4" RIBBED-NECK SCREW	F-RNS-38-34-S	4
			3/8" FLANGED HEX NUT	F-FHN-38-S	4

‡ MARK "√" IN BOX TO INCLUDE IN SUBMITTAL



UL FILE E341872

CABLE CHANNELS EMPLOYING THESE CONNECTORS ARE CLASSIFIED BY UNDERWRITERS LABORATORIES TO BE SUITABLE FOR USE AS EQUIPMENT GROUNDING CONDUCTORS. BONDING JUMPERS ARE NOT REQUIRED TO MAINTAIN GROUND PATH INTEGRITY. RESISTANCE ACROSS COUPLING IS LESS THAN 0.00033 OHMS. CERTIFIED BY U.L. TO MEET NEC. 392 AND NEMA STD. VE1, CSA-C22.2 NO. 126.1.

MATERIAL: ALUMINUM ALLOYS 5052-H32 AND 6063-T6

NOTE: ALL DIMENSIONS ARE SUBJECT TO THE MANUFACTURING TOLERANCE SPECIFICATIONS IN DOCUMENT USP-QA-05-02.

ATKORE

560 WHARTON CIRCLE, SUITE E ATLANTA, GA 30336 USA
 PHONE: 404-696-8585 FAX: 404-696-8599

SHEET NO. 1 OF 1

DIMENSIONS INCHES

DESCRIPTION

VERTICAL ADJUSTABLE SPLICE PLATES FOR CHANNEL

CATALOG NUMBER

SPV-AC(W*)-(F*)4

CATALOG NUMBER VARIABLES

W* = CHANNEL WIDTH (3, 4, 6)
 F* = FASTENER MATERIAL (G OR S)